



SPECIFICATIONS

PSI/Temperature Rating: 400 PSI / 200° F
Cartridge: AISI Type 304 stainless steel AISI Type 17-7PH stainless steel spring
Body Material: Steel pipe schedule 40 (with cast iron grooved end clamps on 2" - 3")
Body Tappings: 1/4" NPT with Temperature test valves¹
Assembly: Valve comes fully assembled. Test Valves extensions are shipped loose.

DIMENSIONS & WEIGHTS (NOMINAL)

All dimensions are for planning purposes only and may change without notice.

SIZE	MODEL NO.	A LENGTH	B HEIGHT	WEIGHT (LBS.)
2"	322	16.0	4.56 ¹	14.6
2-1/2"	323	16.0	4.56 ¹	14.6
3"	310	8.0	4.56 ¹	8.8
4"	311	17.0	8.62	39.0
5"	312	12.0	8.62	35.6
6"	313	12.0	8.62	35.6
8"	314	16.0	12.75	64.6
10"	315	16.0	12.75	91.2
12"	316	28.0	16.00	180.4
14"	317	40.0	20.00	325.0
16"	318	40.0	24.00	450.0
18"	319	40.0	24.00	450.0
20"	370	40.0	24.00	450.0

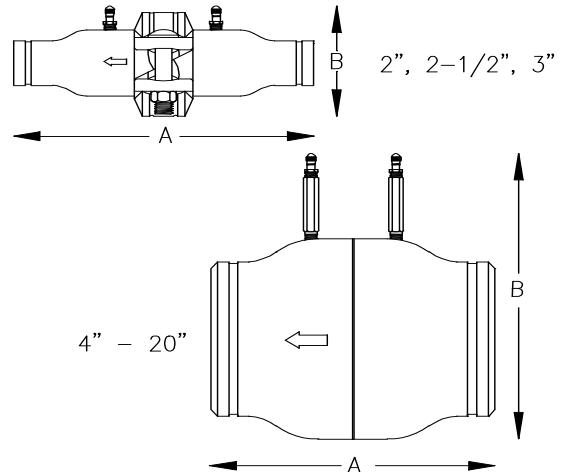

MODEL NUMBER SELECTION²

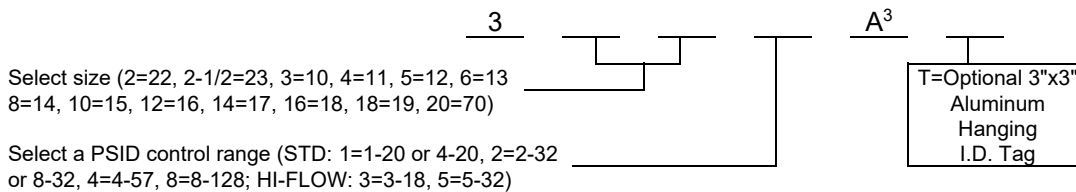

NOTES

- ¹ Valves 4" and larger have extensions pieces for the 1/4" ports. If 4" long extensions pieces are required for 2" to 3" valves add (2) PN 9650 to the order and increase height by 4".
- ² Model no. and flow rate are indicated on label affixed to body.
- ³ Schrader pressure port for flow verification is standard on Grooved End. Replace "A" with "B" for pressure/temperature port.

FLOW RATE TABLES PER TYPE OF CARTRIDGE

TYPE OF CARTRIDGE:		STANDARD FLOW				
LINE SIZE	MODEL NO.	CONTROL RANGE (PSID)	1-20	2-32	4-57	8-128
		HEAD LOSS IN FEET ⁴	3.0	7.4	13.4	30.0
		MIN. AVAILABLE GPM	14	17.5	23.33	35
		GPM INCREMENTS	2.0	2.5	3.33	5.0
2 to 3	322, 323, 310	Maximum GPM	60	75	100	150
4	311	Maximum GPM	180	225	300	450
5	312	Maximum GPM	180	225	300	450
6	313	Maximum GPM	180	225	300	450
8	314	Maximum GPM	360	450	600	900
10	315	Maximum GPM	480	600	800	1,200
12	316	Maximum GPM	840	1,050	1,400	2,100
14	317	Maximum GPM	1,200	1,500	2,000	3,000
16	318	Maximum GPM	1,560	1,950	2,600	3,900
18	319	Maximum GPM	2,040	2,550	3,400	5,100
20	370	Maximum GPM	2,040	2,550	3,400	5,100

TYPE OF CARTRIDGE:		STANDARD FLOW HIGH CAPACITY		
LINE SIZE	MODEL NO.	NOMINAL CONTROL RANGE (PSID)	4-20	8-32
		HEAD LOSS IN FEET ⁴	9.2	18.4
		GPM INCREMENTS	20.0	25.0
2 to 3	322, 323, 310	Minimum GPM	90	110
		Maximum GPM	130	160

TYPE OF CARTRIDGE:		HI - FLOW				
LINE SIZE	MODEL NO.	NOMINAL CONTROL RANGE (PSID)	3-18 (LOW INCREMENTS)	3-18 (HIGH INCREMENTS)	5-32 (LOW INCREMENTS)	5-32 (HIGH INCREMENTS)
		MAX. PRES. DIFF. (PSI)	18	18	32	32
		HEAD LOSS IN FEET ⁴	5.8	5.8	11.5	11.5
		GPM INCREMENTS	2.0	N/A	2.5	N/A
2 to 3	322, 323, 310	Minimum GPM	N/A	N/A	N/A	N/A
		Maximum GPM	N/A	N/A	N/A	N/A
4	311	Minimum GPM	114	300	152.5	535, 560, 600
		Maximum GPM	260		475	
5	312	Minimum GPM	100	300	135	535, 560, 600
		Maximum GPM	260		475	
6	313	Minimum GPM	100	300	135	535, 560, 600
		Maximum GPM	260		475	
8	314	Minimum GPM	100	600	135	1135, 1160, 1200
		Maximum GPM	560		1,075	
10	315	Minimum GPM	100	800	135	1535, 1560, 1600
		Maximum GPM	760		1,475	
12	316	Minimum GPM	100	1,400	135	2735, 2760, 2800
		Maximum GPM	1,360		2,675	
14	317	Minimum GPM	100	2,000	135	3935, 3960, 4000
		Maximum GPM	1,960		3,875	
16	318	Minimum GPM	100	2,600	135	5135, 5160, 5200
		Maximum GPM	2,560		5,075	
18	319	Minimum GPM	100	3,400	135	6735, 6760, 6800
		Maximum GPM	3,360		6,675	
20	370	Minimum GPM	100	3,400	135	6735, 6760, 6800
		Maximum GPM	3,360		6,675	

NOTES

⁴ Head Loss in Feet is provided for pump head calculations. (1 PSI = 2.307 Feet of Water)